

## Marine Dual Drive Motor

- 2 Speed
- Drives pantograph arms and blades to 39"/1000mm
- Available in sweep angles from 40 degrees to 80 degrees
- 304 Stainless steel pivot DIN pivots
- Available in right or left hand park configurations

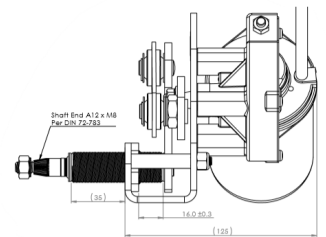
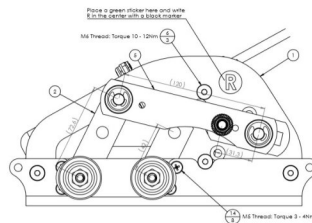
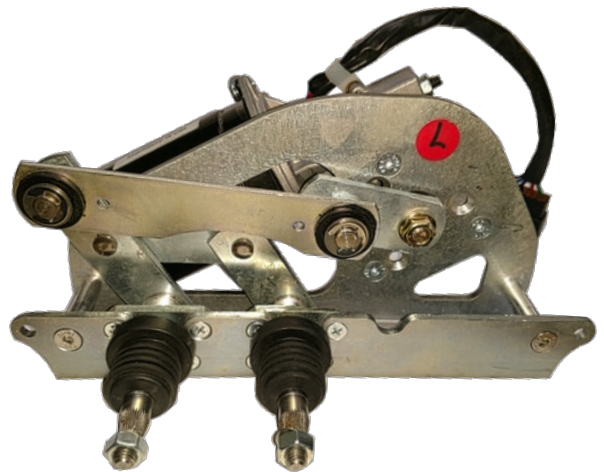

**MOTOR TORQUE:** 12v -55Nm, 24v - 50Nm

**SHAFT LENGTH:** 1.", 1.25", 2", 2.5" or 3"

**SHAFT CONSTRUCTION:** Stainless steel with Al housing

**SHAFT TYPE:** DIN (A12xM8) (per DIN 72783)

**LOW SPEED:** 38 sweeps/minute

**HIGH SPEED:** 60 sweeps/minute

**MOTOR VOLTAGE:** Available in 12v or 24v

**GROUNDING:** Isolated

**FUSING:** 20 amps minimum

**WIRE INSULATION:** Black=Park, Green=Low Speed, White=Ground, Red=High Speed, Brown =ground, Blue=switch

**WIRING:** 16AWG, 7" leads

**PARK CIRCUITRY:** Dynamic park

**PARK POSITIONS:** Available in left or right park configurations

**CONNECTOR:** 6 pin Deutsch

**WEIGHT:** 4Kg / 8.8lb

### Part Numbering Convention

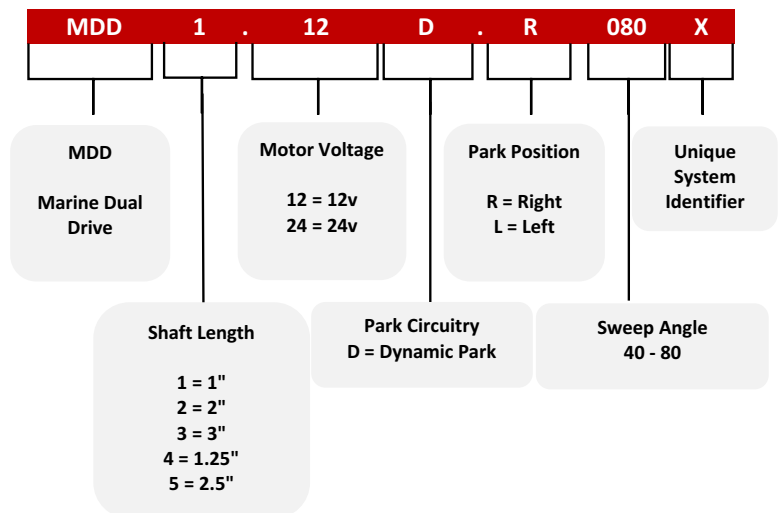

[www.wexcoind.com](http://www.wexcoind.com)  
[customerservice@wexcoind.com](mailto:customerservice@wexcoind.com)

WEXCO Industries  
 3 Barnet Road  
 Pine Brook, New Jersey 07058

(800) 528-3048

200811r1



WELDALL MFG., INC.  
 CERTIFIED TO ISO 9001:2015  
 1000111



Association of  
 Equipment Manufacturers



## Compatible Stainless Steel Pantograph Arms - Adjustable Length

DRY arms are standard. Arms can be converted to WET by ordering wet kit

P/N WE19491. Kit includes spray nozzle, washer fluid hose retainer clip and instructions

PART NUMBER	SHAFT TYPE	LENGTH INCHES	LENGTH MM	COLOR	BLADE CONNECTION
200708DS	DIN	20" - 24"	500 - 600	BLACK	SADDLE
200712DS	DIN	26" - 32"	650 - 800	BLACK	SADDLE
200713DS	DIN	32" - 36"	800 - 900	BLACK	SADDLE
200719DS	DIN	38" - 40"	950 - 1000	BLACK	SADDLE

## Compatible Stainless Steel Wiper Blades

PART NUMBER	LENGTH INCHES	LENGTH MM	BLADE CONNECTION	COLOR	CONSTRUCTION
13620M	20"	500	J - Hook	Black	304 SS, 13.6mm saddle width
13622M	22"	550	J - Hook	Black	304 SS, 13.6mm saddle width
13624M	24"	600	J - Hook	Black	304 SS, 13.6mm saddle width
13626M	26"	650	J - Hook	Black	304 SS, 13.6mm saddle width
13628M	28"	700	J - Hook	Black	304 SS, 13.6mm saddle width
3728SSM	28"	700	J - Hook	Black	304 SS, 13.6mm saddle width
13730SSM	30"	750	Saddle	Black	304 SS, 13.6mm saddle width
13732SSM	32"	800	Saddle	Black	304 SS, 13.6mm saddle width
13734SSM	34"	850	Saddle	Black	304 SS, 13.6mm saddle width
13736SSM	36"	900	Saddle	Black	304 SS, 13.6mm saddle width
13738SSM	38"	950	Saddle	Black	304 SS, 13.6mm saddle width
13740SSM	40"	1000	Saddle	Black	304 SS, 13.6mm saddle width
0120532SS21	32"	800	Saddle	Black	304 SS, 17mm saddle width
0120534SS21	34"	850	Saddle	Black	304 SS, 17mm saddle width
0120536SS21	36"	900	Saddle	Black	304 SS, 17mm saddle width
0120538SS21	38"	950	Saddle	Black	304 SS, 17mm saddle width
0120540SS21	40"	1000	Saddle	Black	304 SS, 17mm saddle width

[www.wexcoind.com](http://www.wexcoind.com)  
[customerservice@wexcoind.com](mailto:customerservice@wexcoind.com)

WEXCO Industries  
 3 Barnet Road  
 Pine Brook, New Jersey 07058

(800) 528-3048

200811r1



WELBALL MFG., INC.  
 CERTIFIED TO ISO 9001:2015  
 1000111

